

# PROPOSED MALE "D" DOVETAIL STANDARD

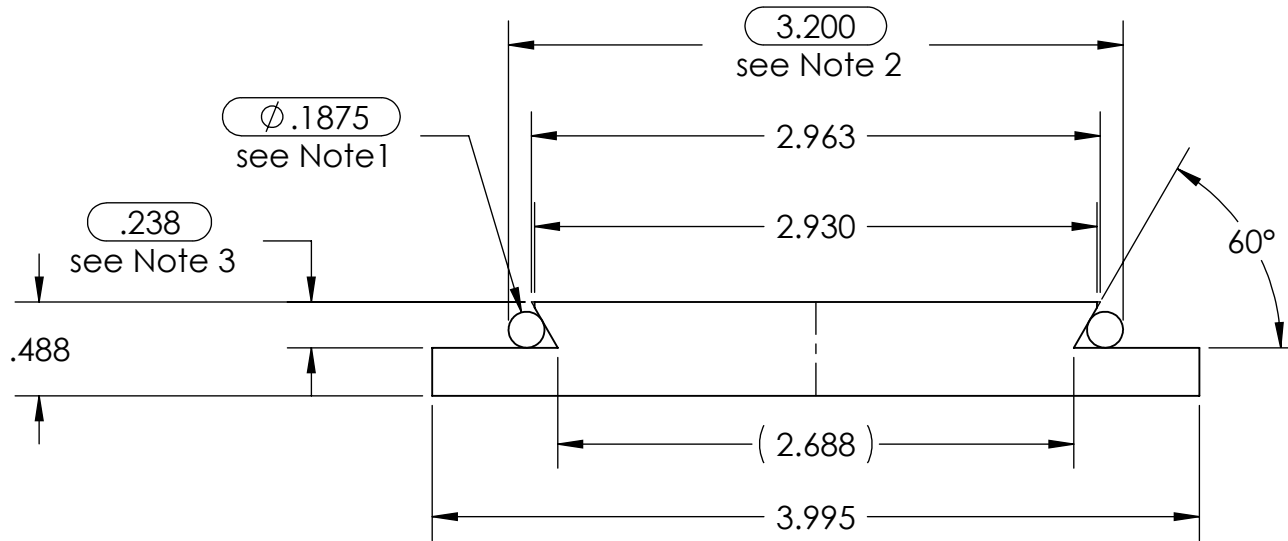

Note 1: use standard 3/16" dowel for MOW measurement  
 available from McMaster-Carr (#98380A514)  
 MIL Spec: MIL 16555  
 Nominal diameter: 3/16"  
 Overall length: 1-1/2"  
 Actual diameter: +.0002 over nominal ±.0001"

Note 2: Nominal MOW = 3.200" ± .020"  
 Acceptable values: 3.180" - 3.220"

Note 3: Nominal Dovetail Height = 0.238" ± .025"  
 Acceptable values: 0.262" - 0.213"

UNLESS OTHERWISE SPECIFIED:		<b>Optec Inc.</b>	
[DIMENSIONS IN MM] DIMENSIONS ARE IN INCHES TOLERANCES: TWO PLACE DECIMAL ±.007 THREE PLACE DECIMAL ±.003		TITLE:  "D" DOVETAIL STANDARD	
MATERIAL 6061-T6 ALUMINUM	SIZE <b>A</b>	DWG. NO. 19-02055	REV 1.1
FINISH SATIN ETCH BLACK	DO NOT SCALE DRAWING		SCALE: 1:1   WEIGHT:   SHEET 1 OF 1